

Ex9L

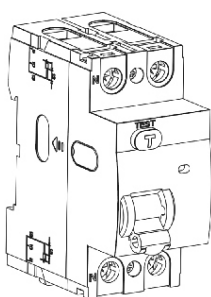

RCCB
Proudový chránič
Prúdový chránič
Wyłącznik różnicowoprądowy
Interrupator diferencial
FI-Schalter
Interrupteur différentiel
УЗО
Diferencijalna zaštitna sklopka

NOARK

Ex9L

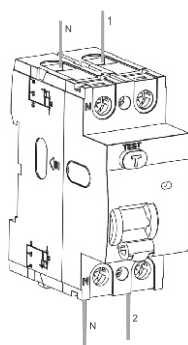

	$\oplus \ominus$ Z2
	1-35mm ²
	2.5Nm

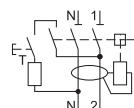

Ex9L

Mounting instructions
Montážní návod
Montážne inštrukcie
Instrukcija montazu
Instrucțiuni de asamblare
Montageanweisung
Instructions de montage
Инструкция по монтажу
Monteringsanvisning
Istruzioni di montaggio
Instrucciones de montaje
Ősszeszerelési útmutató
Uputstvo za montažu

Asennusohjeita
Montage-instructies
Instruções de montagem
Navodila za montažo
Οδηγίες Εγκατάστασης
Инструкции за инсталиране
Monteringsvejledningen
Montažu upute
Surinkimo instrukcijos
Instalēšanas instrukcijas
Скупштина упутство
Paigaldusjuhendid

Ex9L

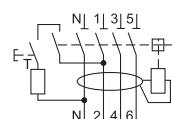
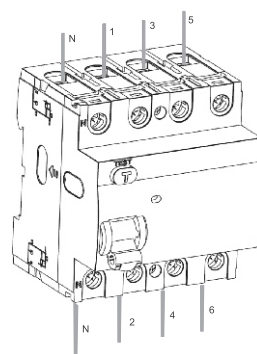

Ex9L

Caution: Installation by electricians only
Varování: Montáž pouze osobou s elektrotech. kvalifikací
Varovanie: Montáž iba osobou s elektrotech. kvalifikáciou
Uwaga: Montaż tylko przez uprawnionych instalatorów
Atenție: Instalare numai de catre electricieni
Vorsicht: Montagenur durch Elektrofachkräfte
Осторожно: Монтаж только электрика
Upozorenje: Montažu izvodi samo stručno lice

Ex9L

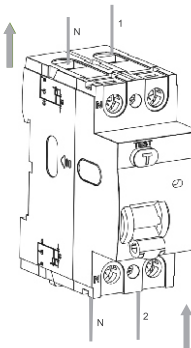
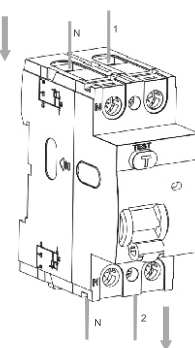

Ex9L

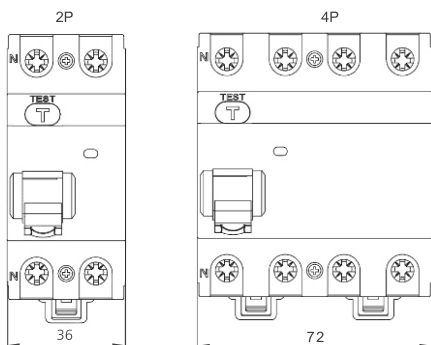

Ex9L

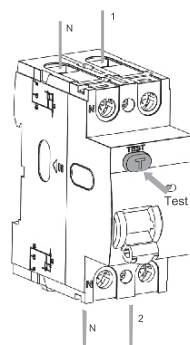

Test monthly
Testovat měsíčně
Testovať mesačne
Test miesięcznie
Test lunar
Test månedlige
Test mensuelle
Испытание ежемесячно
Mesečno testirati

Ex9L

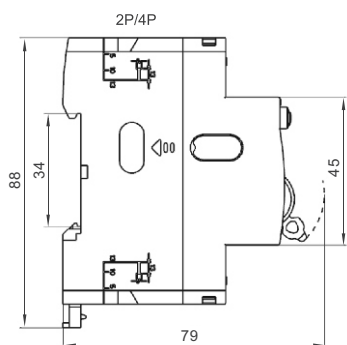

Ex9L

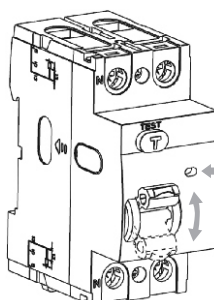

White
Bílá
Biela
Biało
Albă
Weiss
Blanc
Белая
Bela

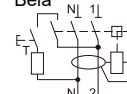

Ex9L

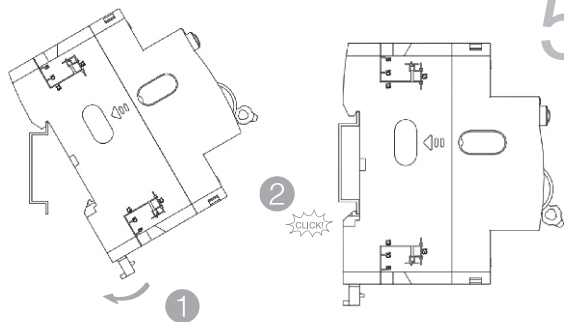

Ex9L

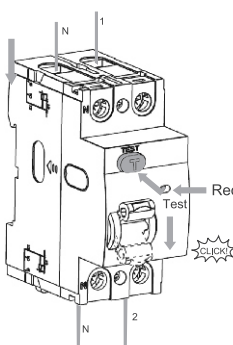

Red
Červená
Czerwoný
Roşu
Rot
Rouge
Красный
Crvena

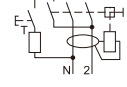

Ex9L

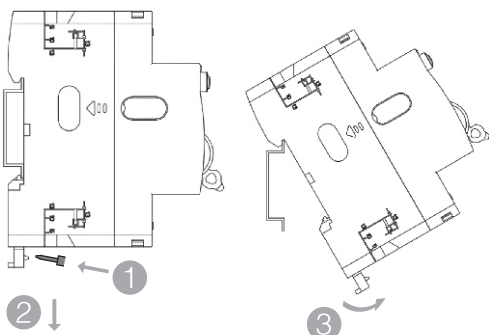

NOARK



Printed with environment-friendly paper
Copyright Noark. All Rights Reserved
Manufacturer: NOARK Electric (Shanghai) Co., Ltd.
3857 Sixian Road, Songjiang District, Shanghai
Importer: NOARK Electric Europe s.r.o. Sezemická
2757/2 | 193 00 Praha 9 | Czech Republic
www.noark-electric.eu
Z9L201710EU